

# MIO - 1" METERS WITH MECHANICAL DISPLAY

The MIO is the medium capacity meter in the M Series range. It has the ability to handle a wide range of fluid viscosities with exceptional levels of repeatability and durability.



MIOARM-X

## Product Benefits

- Compact size.
- Easy to read and operate mechanical display.
- Flexibility of installation options (e.g. can be mounted horizontally or vertically; no flow conditioning required).
- Low pressure drop allows for economical pump selection or gravity flow applications.
- Meter construction enables fast and easy on-site servicing without removal from application.
- Meter accuracy is verified by a factory calibration check after which an individual metrology report is issued.
- Meter design minimises the number of wearable and replaceable parts and extends product life.
- An Option of 100 Pulse per unit of measure output is available for the Analogue version.

MODEL	MIO
METER TYPE	METER WITH MECHANICAL DISPLAY
METER BODY MATERIAL	AA601 ALUMINIUM / 316 STAINLESS STEEL / BRONZE
WETTED COMPONENTS:	
ROTOR MATERIAL	PPS / 316 STAINLESS STEEL
SHAFTS	316 STAINLESS STEEL
O-RING	NBR (NITRILE)
FLOW RATE RANGES (litres per minute/US gallons per minute)	
ABOVE 5 CPS	6 to 120 / 1.6 to 32
BELOW 5 CPS	10 to 100 / 2.6 to 26
ACCURACY- WITHIN (OF READING)	+/- 1% / ANALOGUE REGISTER +/- .05%
REPEATABILITY	0.03%
MAXIMUM VISCOSITY (OF STANDARD MODEL)	1000 Centipoise
MAXIMUM OPERATING PRESSURE	3450kPa/ 500 PSI/ 34.5 BAR OR FLANGE RULE WHERE FITTED
MAX. OPERATING TEMPERATURE	80°C / 176°F, High Temp Option 120°C / 248°F
RECOMMENDED MESH STRAINER SIZE	60 MESH



Mechanical Display



Analogue Mechanical Register

**Port Size** To order flowmeter you must replace 'X' with the relevant number. This number will determine the following specifications:

### Port Size:

- 1 = 1" BSP (F) ports
- 2 = 1" NPT (F) ports
- 3 = 1" ANSI 150lb Flange
- 4 = 1" ANSI 150lb Flange
- 5 = 25mm DIN 16 Flange
- 13=25mm JIS 10K Flange

### Calibrated and Display In:

- Litres
- US Gallons
- Litres
- US Gallons
- Litres
- Litres

PPS = Polyphenylene Sulfide Resins



# MIO - 1" METERS WITH MECHANICAL DISPLAY

## Options & Accessories

MIO - 1" METER MECHANICAL DISPLAY	VITON O-RING	TEFLON O-RING	EPDM O-RING	HIGH TEMP ROTORS	HIGH VISCOSITY ROTORS	HALL EFFECT SENSOR	REED SWITCH	SOLVENT KIT	HASTALLOY C SHAFTS	ANALOGUE REGISTER	PULSE KIT P500	REMOTE MOUNTED LC DISPLAY	HEATING JACKET	4-20mA MODULE
M10ARM-X	O	O	O	O	O	X	X	O	X	O	A	X	A	X
M10ASM-X	O	O	O	S	O	X	X	S	X	O	A	X	A	X
M10SRM-X	O	O	O	O	O	X	X	S	X	O	A	X	A	X
M10SSM-X	O	O	O	S	O	X	X	S	X	O	A	X	A	X
M10BRM-X	O	O	O	O	O	X	X	O	X	O	A	X	A	X

S = Standard

O = Optional

X = Not Available

A = Accessory

## Dimensions

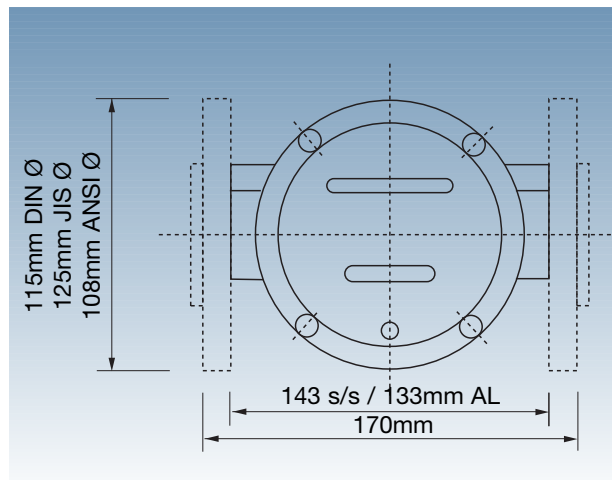

Mechanical Display

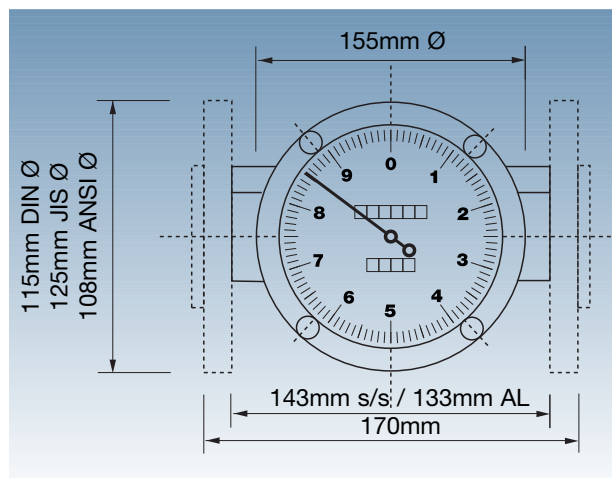
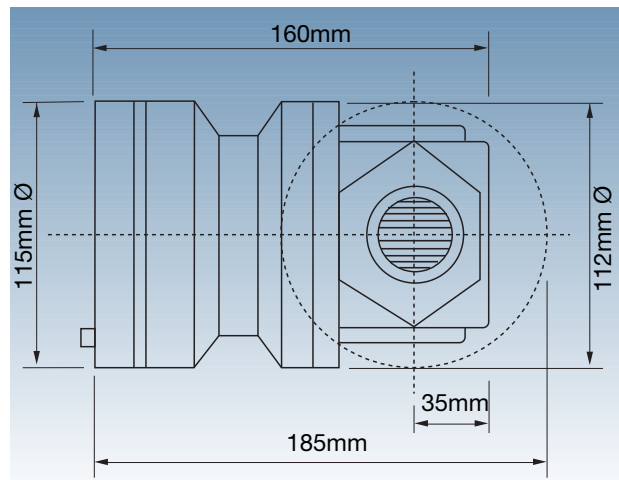

Analogue Mechanical Display

